

PARTS LIST: 25 GAL 322800251

| ITEM | PART NO. | DESCRIPTION |
|------|-----------|-----------------------------------|
| 1 | 385311251 | KIT, 90° ELBOW FITTING |
| 2 | 385310660 | KIT, DIP TUBE-UNIVERSAL (INC. 3) |
| 3 | 385311110 | KIT, SEALING GROMMET 2" |
| 4 | 313255247 | TANK SAVER, 1-1/2" (INC. 3) |
| 5 | 385250020 | KIT, 4010 TANK CAP/O'RING (INC.6) |
| 6 | 385311250 | KIT, O'RING 3-5/8" OD X 3/16" |
| 7 | 385311252 | KIT, FLANGED ADAPTER FITTING |
| 8 | 385311073 | KIT, VENT ELBOW BARBED (INC. 9) |
| 9 | 385311112 | KIT, SEALING GROMMET 3/4" |
| N/S | 600342173 | PLUG, MALE 1 1/2" PVC 0466 |

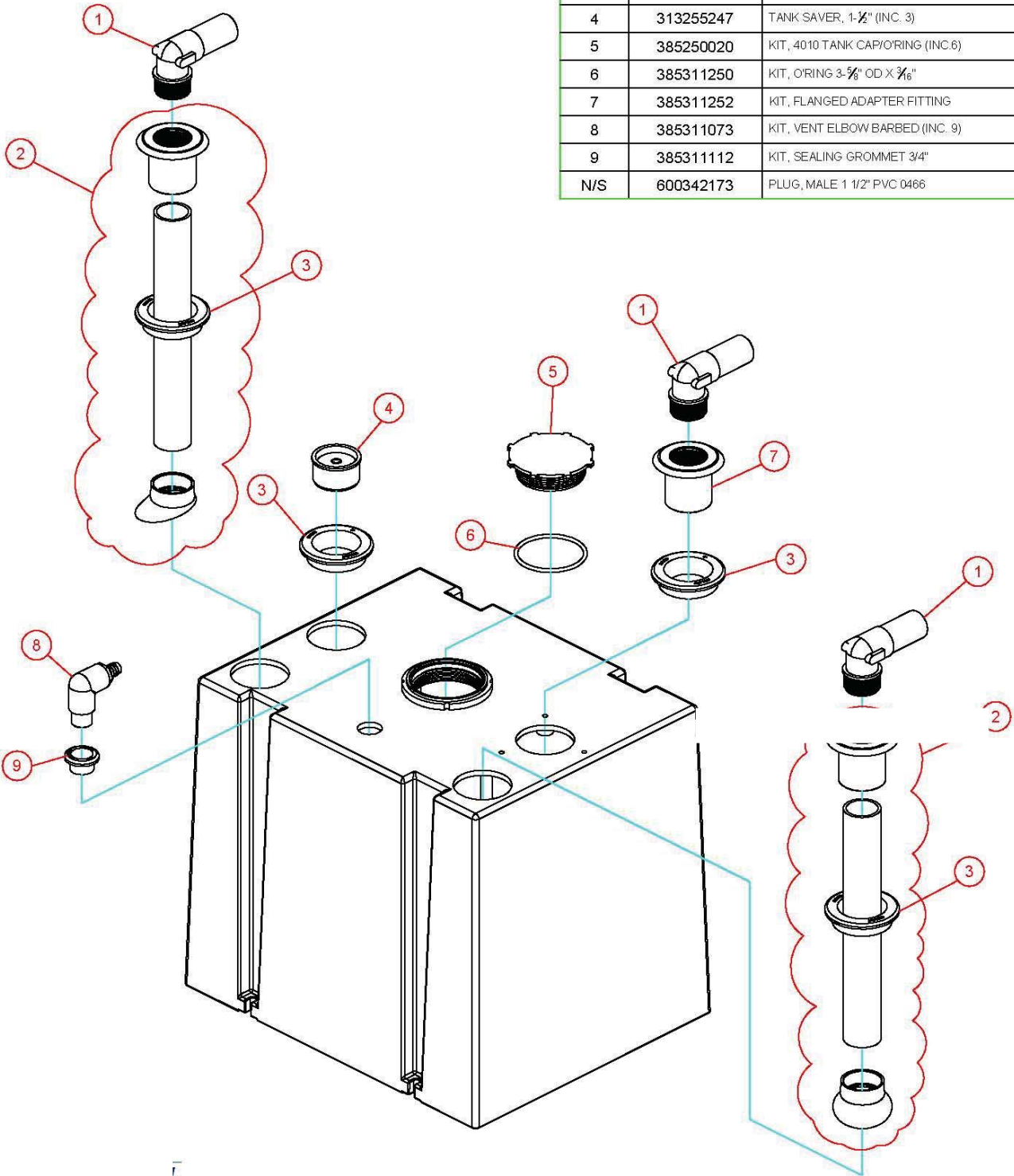

Dometic Corporation - Sanitation Systems
 13128 State Rt. 226, P.O. Box 38
 Big Prairie, OH 44611-0038 USA
 Telephone: 330-496-3211
 Fax: 330-496-3097
 Email: sealand@dometicusa.com